

STANDARD PROFILES

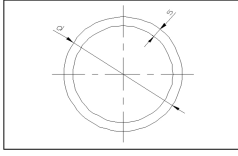

PIPE PROFILES

PROFIL NO	d mm	s mm	kg/mt
1000	7x4.8	1.1	0.055
1001	9.8x7.3	1.25	0.082
1002	10x3.4	3.3	0.188
1003	10x7	1.5	0.108
1004	12x8	2	0.170
1005	12.1x6.1	3	0.229
1006	13x10	1.5	0.146
1007	13.8x7	3.4	0.301
1008	15.5x11	2.25	0.253
1009	15.7x6	4.85	0.448
1010	15.75x13.35	1.2	0.148
1011	15.8x4.85	5.475	0.481
1012	15.8x11.8	2	0.234
1013	15.8x13.9	0.95	0.120
1014	16x6	5	0.468
1015	16x7	4.5	0.440
1016	16x9	3.5	0.372
1017	16x11	2.5	0.287
1018	16x12	2	0.238
1019	17x11	3	0.357
1020	18.8x16.4	1.2	0.179
1021	19x16	1.5	0.223
1022	19x16.6	1.2	0.181
1023	19.6x16.5	1.55	0.239
1024	19.8x5	7.4	0.781
1025	19.8x12.1	3.85	0.522
1026	19.8x13.8	3	0.429
1027	20x16	2	0.306
1028	20x17	1.5	0.236
1029	7.2x5	1.1	0.057
1030	11.5x8.2	1.65	0.138
1031	12x10	1	0.093
1032	14x11.8	1.1	0.120
1033	15x13	1	0.119
1034	16x14	1	0.127
1035	19x17	1	0.153
1036	19.5x17	1.25	0.194
1037	19.5x17.5	1	0.157
1038	22x20	1	0.178
1039	23x20	1.5	0.274
1040	25x21	2	0.391
1041	25x23	1	0.204
1042	25x23.4	0.8	0.164
1043	30x25	2.5	0.585
1044	32.8x30.2	1.3	0.348
1045	15.9x12.9	1.5	0.183
1046	12X9.6	1.2	0.110
1047	22x14	4	0.612
1048	22x16	3	0.485
1049	22x18	2	0.340
1050	22x19	1.5	0.261
1051	22x20	1	0.178
1052	22.8x20.8	1	0.183
1053	23x16	3.5	0.581
1054	23x17	3	0.510
1055	23x20	1.5	0.274
1056	23.8x14	4.9	0.788
1057	24X7	8.5	1.121
1058	24X8.5	7.75	1.072
1059	24X10.5	6.75	0.991
1060	24X11	6.5	0.968

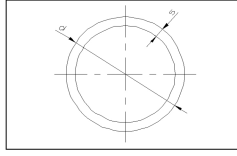

PIPE PROFILES

PROFIL NO	d mm	s mm	kg/mt
1084	30X22	4	0.885
1085	30X24	3	0.689
1086	30X22.5	3.75	0.838
1087	30X20.2	4.9	1.047
1088	30X25	2.5	0.585
1089	30X26	2	0.476
1090	30X27	1.5	0.363
1091	31X24.5	3.25	0.767
1092	32X9	11.5	0.970
1093	32X28	2	0.510
1094	32X28.4	1.8	0.461
1095	32X30	1	0.263
1096	33X27	3	0.766
1097	33.5X7	13.25	2.284
1098	34X26	4	1.021
1099	35X8.5	13.25	2.453
1100	35X27	4	1.055
1101	35X28	3.5	0.938
1102	35X28.5	3.25	0.878
1103	35X29	3	0.817
1104	36.3X20.2	8.05	1.936
1105	36.7X34.1	1.3	0.391
1106	40X24	8	2.179
1107	40X30.5	4.75	1.425
1108	40X32	4	1.255
1109	40X34	3	0.945
1110	40X35	2.5	0.798
1111	40X36	2	0.647
1112	42X40	1	0.349
1113	23X21	1	0.187
1114	26.5x24.3	1.1	0.812
1115	41.2X10	15.6	3.225
1116	42.4X39	1.7	0.589
1117	42.4X39.4	1.5	0.522
1118	44X40	2	0.715
1119	44.5X20.2	12.15	3.346
1120	50X42.8	3.6	1.422
1121	50X40.3	4.85	1.864
1122	50X44	3	1.200
1123	50X45	2.5	1.011
1124	50X46	2	0.817
1125	50X46.4	1.8	0.738
1126	50X38.5	5.75	2.166
1127	51X48	1.5	0.632
1128	54.2X50.3	1.95	0.867
1129	54.8X21.9	16.45	5.370
1130	55X50.3	2.7	1.053
1131	56X53	1.5	0.695
1132	59X56	1.5	0.734
1133	59.8X52.2	3.8	1.811
1134	59.9X57.6	1.15	0.575
1135	60X55	2.5	1.223
1136	60X56	2	0.987
1137	60X57	1.5	0.747
1138	60X57.8	1.1	0.551
1139	50x47	1.5	0.620
1140	45X40.5	2.25	0.818
1141	42X40	1	0.349
1142	41.4X37.4	2	0.671
1143	42.7X5.2	18.75	3.823
1144	44.1X38.1	3	1.049
1145	65X60	2.5	1.330

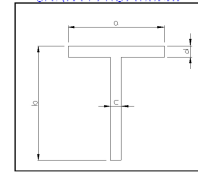

T PROFILES

PROFIL NO	a mm	b mm	c mm	d mm	kg/mt
1200	13	15.4	2.5		0.164
1201	15	15	1.2	1.2	0.093
1202	20	20	1.2	1.2	0.126
1203	20	20	2	2	0.205
1204	20	40	3	3	0.463
1205	25	25	1.2	1.2	0.158
1206	30	15	1.5	1.5	0.176
1207	30	30	1.2	1.2	0.189
1208	30	30	2	2	0.314
1209	35	35	1.7	1.7	0.314
1210	50	30	4	4	0.824
1211	50	50	2	2	0.531
1212	50	50	5	5	1.287
1213	50	37.5	5	2.5	0.824
1214	41	20	2	2	0.314
1215	50	50	1.8	1.8	0.432

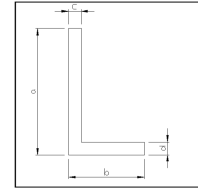

L PROFILES

PROFIL NO	a mm	b mm	c mm	d mm	kg/mt
*1250	8	70	1.2	1.5	0.302
1251	10	15	1.3	1.3	0.083
1252	10	15	1.5	1.5	0.095
1253	15	10	1.2	1.2	0.077
1254	15	25	5	5	0.473
*1255	18.95	11.45	5.95	2.95	0.285
*1256	25	10	5	5	0.406
1257	25	35	3	3	0.463
1258	27	5	1.5	1.5	0.123
*1259	30	10	2	2	0.204
1260	30	15	1.2	1.2	0.146
*1261	30	15	2	2	0.231
1262	30	25	2	2	0.287
*1263	34.5	12	2	2	0.239
1264	40	20	1.3	1.3	0.206
*1265	40	21.5	2	2	0.322
*1266	40.9	15	1.5	1.5	0.217
1267	50	25	3	3	0.573
1268	50	40	5	5	1.151
1269	60	20	1.5	1.5	0.319
*1270	60	53	3	3	0.899
1271	60	40	1.5	1.5	0.410
*1272	40	90	1.4	1.4	0.486
1273	70	50	4	4	1.256
*1274	80	53	3	3	1.062
*1275	100	53	3	3	1.224
*1276	12	84.5	1.3	1.3	0.333
*1277	53	120	3	3	1.387
*1278	53	140	3	3	1.549
*1279	53	160	3	3	1.712
1280	10	15	1.3	1.3	0.083
1281	10	20	1.2	1.2	0.093
*1282	13	35	4	4	0.471
*1283	15	25	2	2	0.205
1284	10	30	1.2	1.2	0.124
1285	15	30	1.2	1.2	0.142
1286	15	30	2	2	0.233
1287	10	40	2	2	0.260
1288	30	20	1.3	1.3	0.171
1289	20	40	1.5	1.5	0.235
1290	20	40	2	2	0.311
1291	20	60	1.2	1.2	0.256
1292	20	40	1.2	1.2	0.191
1293	150	20	1.8	1.8	0.820
1294	20	40	3	3	0.463
1295	95	65	2.2	2.2	0.940
1296	25	35	5	5	0.745
1297	27	24	2	2	0.250
1298	40	65	5	5	1.354

STANDARD PROFILES

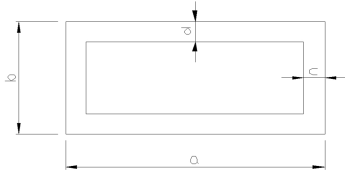

RECTANGULAR PROFILES

PROFIL NO	a mm	b mm	c mm	d mm	kg/mt
*1400	20.2	10.2	1.5	1.5	0.222
*1401	25	15	1.5	1.5	0.300
*1402	25	17	1.2	1.2	0.257
*1403	25	20	1.5	1.5	0.341
*1404	41	26	2.5	2.5	0.840
*1405	30	10	1	1	0.205
*1406	30	15	0.6	0.6	0.149
*1407	30	15	1	1	0.233
*1408	33	15	1.5	1.5	0.365
*1409	33	38	3.75	3.75	1.218
1410	35	20	2	2	0.552
*1411	40	20	1.9	1.9	0.551
1412	40	20	1.2	1.2	0.374
1413	40	20	1.6	1.6	0.492
*1414	40	20	2	2	0.597
*1415	40	25	1.5	1.5	0.504
*1416	40	30	1.5	1.5	0.544
*1417	40	30	2	2	0.714
*1418	50	15	1.2	1.2	0.407
*1419	50	15	2.5	2.5	0.812
*1420	50	25	2.9	2.9	1.087
*1421	50	30	1.8	1.8	0.744
*1422	50	30	2	2	0.823
1423	50	40	1.2	1.2	0.559
1424	50	40	1.6	1.6	0.745
1425	50	40	2	2	0.932
*1426	60	30	1.4	1.4	0.661
1427	60	40	1.7	1.7	0.890
1428	60	40	2	2	1.040
1429	65	40	2	2	1.094
*1430	68	33	3.75	3.75	1.819
1431	69	29	1.1	1.1	0.540
1432	69	29	2	2	1.018
1433	75	32	1.2	1.2	0.680
1434	75	32	2	2	1.116
1435	75	32	1.2	1.2	0.680
1436	75	32	3	3	1.642
1437	80	40	1.6	1.6	1.003
1438	80	40	2	2	1.257
1439	80	20	1.6	1.6	0.839
1440	80	50	1.8	1.8	1.232
1441	80	50	3	3	2.016
*1442	86.5	36.5	3	3	1.800
1443	90	45	2	2	1.420
1444	95	50	1.6	1.6	1.229
1445	100	20	1.6	1.6	1.012
1446	100	40	1.7	1.7	1.258
1447	100	50	2	2	1.582
1448	120	40	1.7	1.7	1.428
1449	120	60	2	2	1.907
1450	135	50	1.8	1.8	1.769
1451	150	50	2	2	2.124
1452	200	50	2.2	2.2	2.928
1453	17.3	16.5	1.2	1.2	0.204
1454	20	18	1.5	1.5	0.282
1455	25	15	1.2	1.2	0.243
1456	28	22	1.5	1.5	0.379
1457	30	20	1.1	1.1	0.284
1458	30	25	1.1	1.1	0.314
1459	40	30	1.1	1.1	0.404
1460	40	15	1.1	1.1	0.318
1461	40	20	1	1	0.314
1462	40	20	2	2	0.607
1463	50	40	1.2	1.2	0.569
1464	50	40	1.05	1.05	0.500
1465	50	40	1.2	1.2	0.569
1466	60	20	1.4	1.4	0.585
1467	68.68	28.28	1	1	0.514
1468	71	31	0.8	0.8	0.434
1469	50	30	3	3	1.202

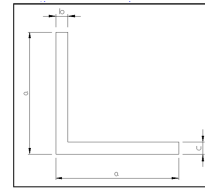

ANGLE PROFILES

PROFIL NO	a mm	b mm	c mm	kg/mt
1500	15	15	1.2	0.084
1501	20	20	1.2	0.126
1502	20	20	1.6	0.166
1503	20	20	2	0.205
1504	20	20	8	0.693
1505	25	25	1.2	0.100
1506	25	25	1.6	0.209
1507	25	25	2	0.260
1508	25	25	3	0.382
1509	30	30	1.2	0.191
1510	30	30	1.5	0.237
1511	40	40	1.2	0.256
1512	40	40	2	0.422
1513	40	40	4.7	0.959
1514	40	40	5	1.016
1515	40	40	3	0.626
1516	40	40	4	0.823
1517	50	50	1.3	0.347
1518	50	50	2	0.530
1519	50	50	3	0.787
1520	60	60	2	0.638
1521	10	10	1.5	0.075
1522	15	15	1.5	0.115
1523	20	20	2	0.205
1524	25	25	3	0.382
1525	30	30	1	0.159
1526	30	30	3	0.463
1527	40	40	2	0.418
1528	40	40	4	0.823
1529	32	32	2.5	0.416
1530	50	50	5	1.287
1531	60	60	6	1.853
1532	45	45	2	0.476
1533	25	25	5	0.610

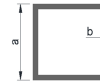

BOX PROFILES

PROFIL NO	a mm	b mm	kg/mt
*1575	10	1.8	0.159
*1576	12	2	0.214
*1577	13.8	2	0.253
*1578	15	1.5	0.218
*1579	15	2	0.281
*1580	16	1.5	0.236
*1581	18	1.9	0.304
*1582	20	1.2	0.244
*1583	20	2	0.389
1584	25	1.2	0.309
*1585	25	1.8	0.435
*1586	27.5	1.4	0.396
*1587	32	2	0.613
1588	40	1.1	0.459
1589	40	1.2	0.504
1590	40	1.6	0.661
*1591	40	1.9	0.757
1592	40	2	0.823
*1593	40	3	1.200
1594	40	4	1.560
*1595	42.8	1.1	0.474
1596	45	1.8	0.842
1597	45	3	1.365
1598	50	1.2	0.634
*1599	50	2	1.040
*1600	50	3	1.527
1601	55.1	2	1.148
1602	60	1.6	1.003
1603	60	2	1.257
1604	60	3	1.853
1605	69.8	1.85	1.362
1606	80	1.7	1.442
1607	100	1.8	1.916
1608	20	1.1	0.225
1609	30	1.1	0.344
1610	40	1.1	0.459
1611	20.5	1.75	0.354

* RADIUS

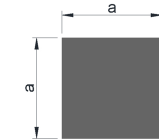

SQUARE BARS

PROFIL NO	a mm	kg/mt
1550	40	4.333
1551	35	3.317
1552	13	0.433
1553	15	0.604
1554	18	0.877
1555	50	6.774

STANDARD PROFILES

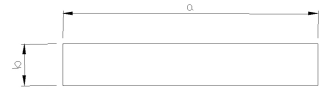
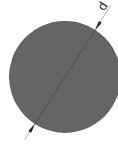

ROUND BARS

PROFIL NO	d mm	kg/mt
1850	4	0.034
1851	6	0.076
1852	7	0.104
1853	7.8	0.129
1854	9	0.172
1855	10	0.212
1856	12	0.306
1857	13	0.359
1858	14	0.417
1859	16	0.544
1860	17	0.615
1861	18	0.689
1862	20	0.851
1863	21.05	0.943
1864	22	1.030
1865	23	1.125
1866	24	1.255
1867	25	1.330
1868	26	1.438
1869	28	1.668
1870	30	1.915
1871	35	2.607
1872	36.3	2.804
1873	40	3.405
1874	42.7	3.880
1875	44	4.120
1876	50	5.321
1877	53	5.978
1878	56	6.664
1879	60	7.662
1880	60	7.662
1881	64	8.718
1882	68	9.841
1883	77	12.619
1884	6	0.076
1885	7.7	0.126
1886	55	6.438

LAMA PROFILES

PROFIL NO	a mm	b mm	kg/mt
1800	12	1.6	0.052
1801	12	3	0.097
1802	15	2.5	0.100
1803	15	3.1	0.126
1804	15	3	0.121
1805	20	4.5	0.241
1806	25	2.5	0.196
1807	25	3	0.203
1808	25	5	0.338
1809	30	2	0.162
1810	30	6	0.487
1811	30	6.75	0.548
1812	40	3	0.325
1813	60	2	0.325
1814	61	6	0.989
1815	70	3	0.569
1816	75	7	1.422
1817	100	3.5	0.939
1818	105	2	0.569
1819	110	2.5	0.737
1820	126	2.5	0.853
1821	20	2	0.108
1822	20	5	0.271
1823	24.9	8	0.539
1824	25	2	0.135
1825	40	3	0.325
1826	40	10	1.084
1827	30	10	0.813

RADIUS LAMA

PROFIL NO	a mm	b mm	r mm	kg/mt
1700	10	2	0.25	0.054
1701	15	3	0.25	0.121
1702	16	5	0.5	0.216
1703	18	2.5	.03	0.121
1704	20	3	0.5	0.162
1705	25	10	2	0.668
1706	25.8	9.4	1	0.654
1707	30	4	0.25	0.325
1708	35	5	0.5	0.473
1709	35	10	0.5	0.947
1710	35	35	1	3.317
1711	40	2	0.3	0.216
1712	40	6	0.5	0.649
1713	40	8	2	0.857
1714	40	10	0.5	1.083
1715	40	40	1	4.333
1716	42.5	5	0.5	0.575
1717	45	4	0.5	0.487
1718	45	12	0.3	1.463
1719	50	3	0.5	0.405
1720	50	4	0.5	0.541
1721	50	5	0.5	0.676
1722	50	6	0.5	0.812
1723	50	10	0.5	1.354
1724	53	3.5	0.5	0.502
1725	50	20	3	2.689
1726	60	4	0.3	0.650
1727	60	5	0.5	0.812
1728	80	9.9	0.5	2.145
1729	80	30	5	6.445
1730	100	10	1	2.707
1731	120	4	1	1.298
1732	125	3	0.5	1.015
1733	141	3	0.5	1.145
1734	150	10	0.5	4.064
1735	100	5	0.5	1.354
1736	61	6	1	0.989
1737	166	6	1	3.056
1738	76	8	-	1.642
1739	30	8.00	3.00	0.638
1740	85	5.0	0.5	1.152
1741	12	5.0	0.25	0.262
1742	13.9	8.9	0.25	0.335
1743	27	16	1	1.171
1744	30	8	3	0.638
1745	30	5	5	0.405
1746	25	8	0.5	0.540
1747	80	40	1	8.670
1748	100	50	1	13.548
1749	100	35	1	9.482
1750	17	4	2	0.174
1751	17.7	2.8	1.4	0.129
1752	18	3	1.5	0.141
1753	20	6	3	0.304
1754	21	2	1	0.111
1755	23.1	1.2	0.6	0.074
1756	25	2.8	1.4	0.185
1757	32	3	1.5	0.254
1758	34.65	2.8	1.4	0.255
1759	40	6	3	0.629
1760	80	6	3	1.279
1761	80	7	3.5	1.480
1762	100	7	3.5	1.869
1763	10	1.2	0.6	0.031
1764	10	2	1	0.051
1765	20	3	1.5	0.157
1766	21.5	3.5	1.75	0.198
1767	25	4	2	0.261
1768	30	3	1.5	0.238
1769	40	4	2	0.424

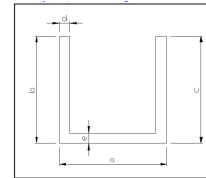

U PROFILES

PROFIL NO	a mm	b mm	c mm	d mm	e mm	kg/mt
1900	13	35	35	4	4	0.790
*1901	13.1	20.8	20.8	1.3	1.3	0.188
*1902	15	15	15	2	2	0.221
*1903	16.5	27	27	1.6	1.6	0.290
1904	17	17	17	1.1	1.1	0.145
*1905	17	20	20	3	4	0.444
*1906	17	40	40	3	4	0.769
1907	18	20	20	1.1	1.1	0.165
*1908	18.1	19.1	19.1	1.5	1.5	0.218
*1909	20	6.46	6.46	2	1.5	0.134
*1910	20	20	20	2	2	0.303
*1911	20	30	30	2	2	0.411
*1912	20	40	40	2	2	0.519
*1913	20.5	25	25	1.24	1.24	0.226
*1914	20.5	8	8	1.1	1.1	0.101
1915	21.2	25	25	1.2	1.2	0.223
*1916	23	20	20	1.7	1.7	0.270
*1917	23	23	23	1.5	1.5	0.268
*1918	25	25	25	3	3	0.609
*1919	35	35	35	1.9	1.9	0.520
1920	40	40	40	4	4	1.210
*1921	44	16.1	16.1	2	1.5	0.336
*1922	45.3	20.5	20.5	1.2	1.2	0.273
1923	50	35	35	1.5	1.5	0.475
*1924	50	50	50	2.3	2.3	0.906
*1925	54	19.36	19.36	2	1.5	0.412
*1926	70	27.5	27.5	2	2	0.56
*1927	83	25	25	6	6	1.967
1928	12	12	2	2	2	0.172
1929	19.3	12	12	1.4	1.4	0.152
1930	19	12	12	1.4	1.4	0.151
1931	12	8	8	1	1	0.079